

# JVC

## SERVICE MANUAL

### LECTEUR DVD Hi-Fi VIDÉO MAGNÉTOSCOPE

## HR-XV1MS

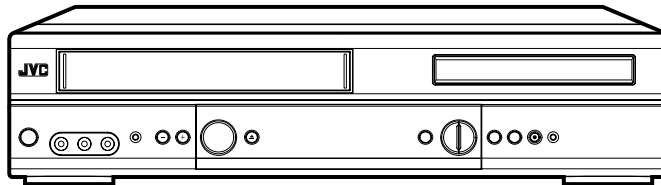
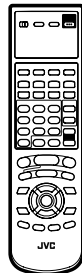

Regarding service information other than these sections, refer to the service manual No. 82927 (HR-XV1EU-C). Also, be sure to note important safety precautions provided in the service manual.

### Caractéristiques techniques

#### GENERAL

Fonctionne sur courant: AC 230V 50Hz  
Consommation électrique: marche: 22W  
veille: 5W  
Poids: 4.5 kg  
Dimensions: largeur: 430 mm  
Hauteur: 99 mm  
profondeur: 310.5 mm  
Niveau d'entrée: Prise SCART: VIDEO: 1 Vp-p, 75  $\Omega$   
AUDIO: 500 mV, 50 k $\Omega$   
Niveau de sortie: Audio IN jack: 500 mV, 50 k $\Omega$   
Prise SCART: VIDEO: 1 Vp-p, 75  $\Omega$   
AUDIO: 500 mV, 1 k $\Omega$   
Audio OUT jack: 500 mV, 1 k $\Omega$   
Hi-Fi Distorsion de fréquence: 20Hz to 20,000Hz  
Hi-Fi Gamme d'amplification: More than 75dB

#### Magnétoscope

Signal couleur: PAL et SECAM Lecture NTSC  
Tête vidéo: 4 têtes rotatives  
Piste audio: Son Hi-Fi - 2 pistes/son mono - 1 piste  
Couverture des canaux: 2-12, X, Y, Z, S1-S41, 21-69  
Durée rembobinage rapide: Environ 1 minute 48 secondes  
(avec une cassette E-180) (à + 25°C)

#### Lecteur DVD

Système de signal: PAL  
Disque compatibles: DVD (12cm, 8cm), CD (12cm, 8cm)  
Caractéristiques audio: DVD: 4Hz - 22KHz  
CD: 4Hz - 20KHz  
Distorsion de fréquence: 90dB  
Taurapport signal/bruit: 0.1%  
Distorsion harmonique: En dessous des seuils de mesure  
scintillement et pleurage: 90dB  
Gamme d'amplification: sortie: Audio: (RCA) 500 mV, 1Kohm  
Digital Audio: 0.5Vp-p/75 ohm  
Micro: CD: longueur d'onde: 775 - 805 nm  
Sortie maximum: 0.5 mW  
DVD: longueur d'ondes: 640 - 660 nm  
Sortie maximum: 1.0 mW

#### ACCESSOIRES:

Télécommande x 1  
Câble coaxial 75 ohm x 1  
Câble Scart x 1  
Pile (UM-3) x 2

HR-XV1MS V14PV1



# TABLE OF CONTENTS

DIFFERENT TABLE ..... 1 only

WHEN REPLACING EEPROM(MEMORY) IC ..... 1 only

2. CHARTS AND DIAGRAMS (2-1 to 2-13)

    Y/C/AUDIO/H.AMP SCHEMATIC DIAGRAM ..... 2-1

    MICOM SCHEMATIC DIAGRAM ..... 2-3

    TUNER/JACK SCHEMATIC DIAGRAM ..... 2-5

    SUB MICOM/OSD/VPS SCHEMATIC DIAGRAM ..... 2-7

    PRINTED CIRCUIT BOARD VCR ..... 2-9

3. PARTS LIST (3-1 to 3-7)

3.1 PACKING AND ACCESSORY ASSEMBLY <M1> ..... 3-1

3.2 ELECTRICAL PART LIST

    VCR BOARD ASSEMBLY<03> ..... 3-2

4. REFERENCE (4-1 to 4-6)

    GENERAL SPECIFICATIONS ..... 4-1

The following table indicates main different points between models HR-XV1EU-C and HR-XV1MS.

ITEM	MODEL	HR-XV1EU-C	HR-XV1MS
VIDEO SYSTEM		PAL	PAL/SECAM/MESECAM
RF OUT		USED	NOT USED
VPS		USED	NOT USED
21 PIN CABLE		OPTIONAL	PROVIDED

The following table indicates different parts number between models HR-XV1EU-C and HR-XV1MS.

### PACKING AND ACCESSORY ASSEMBLY<M1>

PACKING AND ACCESSORY ASSEMBLY<M1> is indicated on the parts list.

### FINAL ASSEMBLY<M2>

REF NO.	ITEM	MODEL	HR-XV1EU-C	HR-XV1MS
△601	CABINET,FRONT ASSY		X-A2A735B720	X-A2A779D720
608	CABINET,FRONT		X-701WPJB706	X-701WPJ1135

### VCR BOARD ASSEMBLY<03>

REF NO.	ITEM	MODEL	HR-XV1EU-C	HR-XV1MS
△PW1	VCR BOARD ASSY		X-A2A735B010	X-A2A779D010B

## WHEN REPLACING EEPROM (MEMORY) IC

If a service repair is undertaken where it has been required to change the MEMORY IC, the following steps should be taken to ensure correct data settings while making reference to TABLE 1.

**NOTE: No need setting for after INI FD.**

INI	+0	+1	+2	+3	+4	+5	+6	+7	+8	+9	+A	+B	+C	+D	+E	+F
B0	---	---	---	---	---	---	---	---	---	8B	C9	D2	71	62	76	08
C0	B2	17	90	50	60	F1	54	51	51	51	B2	9F	97	8E	04	FA
D0	D9	64	2A	08	02	FF	40	00	71	9F	82	02	42	35	63	5B
E0	76	5F	08	F0	0A	FB	5F	08	F0	05	F2	5F	09	F0	05	F3
F0	16	2F	9F	42	42	80	3D	68	08	89	04	3A	CC	---	---	---

[TABLE 1]

1. Turn on the POWER.
2. Press both CH UP button on the set and the FF button on the set for more than 2 seconds. ADDRESS and DATA will appear on FIP as Fig 1.
3. ADDRESS is now selected and should "blink". Using the SET + or - button on the remote, step through the ADDRESS until required ADDRESS to be changed is reached.
4. Press OK to select DATA. When DATA is selected, it will "blink".
5. Again, step through the DATA using SET + or - button until required DATA value has been selected.
6. Pressing OK will take you back to ADDRESS for further selection if necessary.
7. Repeat steps 3 to 6 until all data has been checked.
8. When satisfied correct DATA has been entered, turn POWER off (return to STANDBY MODE) to finish DATA input.

The unit will now have the correct DATA for the new MEMORY IC.

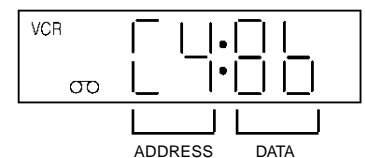

Fig. 1



## GENERAL SPECIFICATIONS

<b>G-1</b>	<b>Outline of the product</b>		DVD VIDEO PLAYER & VHS Player / Recorder		
<b>G-2</b>	<b>DVD System</b>	Color System	PAL		
		Disc	DVD, CD-DA, CD-R/RW, VIDEO CD		
		Disc Diameter	120 mm , 80 mm		
		Deck	Disc Loading System		
			Motor	Front Disc Loading 3 Motors	
		Pick up		1-Lens 2-Beams System	
		Playback time (Max)	DVD 1-Layer	135min (4.7GB)	
			DVD 2-Layer	245min (8.5GB)	
			CD	74min	
			VIDEO CD	74min	
		Search speed	Actual	Fwd	2-100 times / 4 step (DVD) 4-8 times / 2 step (CD) 5-15 times / 2 step (VIDEO CD) 2-70 times (DVD) 4-12times (CD) 4-18times (VIDEO CD)
				Rev	2-100 times / 4 step (DVD) 4-8 times / 2 step (CD) 5-15 times / 2 step (VIDEO CD) 2-70 times (DVD) 4-12times (CD) 4-18times (VIDEO CD)
Slow speed	Actual			Fwd 1/8-1/2 times (DVD, VIDEO CD) 1/7-1/2 times (DVD, VIDEO CD)	
	Actual			Rev -- --	
<b>G-3</b>	<b>VCR System</b>	System	VHS Player / Recorder		
		Video System	PAL/SECAM/MESECAM		
		Hi-Fi STEREO	Yes		
		NTSC PB(PAL60Hz)	Yes		
		Deck	DECK		
			Loading System	OVD-7 Front	
			Motor	3	
		Heads	Video Head	4Head	
			FM Audio Head	2Head	
		Audio /Control		Mono/Yes	
		Erase(Full Track Erase)		Yes	
		Tape Rec	PAL	SP/LP	
			NTSC	-	
		Speed Play	PAL	SP/LP	
			NTSC	SP	
		Fast Forward / Rewind Time (Approx.) at 25 °C		FF:1'48"/REW:1'48"	
			with Cassette	E-180	
		Forward/Reverse	NTSC or PAL-M	SP=3x, 5x	
Picture Search	PAL or SECAM	SP/LP=5x, 7x / 7x, 13x			
Frame Advance		1/10			
Slow Speed		1/5, 1/10,1/30			
<b>G-4</b>	<b>Tuning System</b>	Broadcasting System	CCIR,FRENCH System BG,L		
		Tuner and	System		
		Receive CH	Destination	Oscar(W/HYPER) , France CATV	
			Tuning System	F-Synth	
			Input Impedance	VHF/UHF 75 OHM	
		CH Coverage	(SECAM)	F2-F4, FB-FQ, F21-F69	
			(PAL)	E2-E4, X-Z+2, S1-S10, E5-E12,S11-S41,E21-E69	
		Intermediate	Picture(FP)	PAL/SECAM(U&VH)/SECAM(VL) 38.9 / 38.9 / 34.4MHz	
		Frequency	Sound(FS)	33.4 / 32.4 / 40.9MHz	
			FP-FS	5.5 / 6.5 / 6.5MHz	
		Preset CH		80CH	
		RF Converter Output		No	
		Channel		-	
		Level/Impedance		-	
		Sound Selector		No	
Stereo/Dual TV Sound		G.ST/NICAM DUAL			
Tuner Sound Muting		Yes			
<b>G-5</b>	<b>Power</b>	Power Source	AC 230V 50Hz DC -		
		Power Consumption	22 W at 230V 50Hz		
			Stand by	5 W at 230V 50Hz	
			Per Year	-- W	
		Protector	Power Fuse	Yes	
<b>G-6</b>	<b>Regulation</b>	Safety	CE		
		Radiation	CE		
<b>G-7</b>	<b>Temperature</b>	Operation	5°C - 40°C		
		Storage	-20°C - 60°C		
<b>G-8</b>	<b>Operating Humidity</b>		Less then 80% RH		

## GENERAL SPECIFICATIONS

G-9	Signal	Video Signal	Output Level	1 V p-p/75 ohm (DVD,VCR)
			S/N Ratio (Weighted)	65 dB(DVD) 53 dB(VCR)
			Horizontal Resolution	500 Lines (DVD) 240 Lines(VCR at SP)
		RGB Signal	Output Level	0.7V p-p / 75 ohm
		Audio Signal (0dB=0.775Vrms)	Input Level Microphone	-
			Input Level Line	-3.8 dBm/ 50k ohm(VCR)
			Output Level Line	-3.8 dBm/ 1k ohm(DVD,VCR)
			Digital Output Level	0.5 V p-p / 75 ohm(DVD)
			S/N Ratio at (Weighted)	90dB(DVD) 42dB(VCR at SP)
			Harmonic Distortion (1KHz) Typical	0.1% (DVD) 1.5% (VCR at SP)
			Frequency Response: DVD Mode at DVD	4 Hz - 22 KHz
			DVD Mode at VIDEO CD	4 Hz - 20 KHz
			DVD Mode at CD	4 Hz - 20 KHz
			VCR Mode at SP	100Hz - 10 KHz
		VCR Mode at LP	100Hz - 5 KHz	
		VCR Mode at SLP	-	
		Hi-Fi Audio Signal	Dynamic Range : More than	75dB
			Frequency Response	20Hz ~20KHz
			Wow And Flutter : Less than	0.01 %Wrms
			Channel Separation : More than	60 dB
Harmonic Distortion : Less than	1%			
G-10	On Screen Display (DVD)	Menu	Yes	
		Menu Type	Icon	
		Picture	Yes	
		TV Shape	Yes	
		PAL/Auto	No	
		Video Out Select	Yes	
		Output Sound	Yes	
		Audio Out Select	Yes	
		Dynamic Range Control	Yes	
		Karaoke Vocal	Yes	
		Language	Yes	
		On-Screen Language	Yes	
		Disc Menu Language	Yes	
		Audio Language	Yes	
		Subtitle Language	Yes	
		Display	Yes	
		On-Screen Displays	Yes	
		Background	Yes	
		Screen Saver	Yes	
		Operational	Yes	
		Pause/Still	Yes	
		Parental Lock	Yes	
		Title Stop	Yes	
		PBC	Yes	
		Initial Setup	Yes	
		On-Screen Displays	Yes	
		TV Shape	Yes	
		Audio Out Select	Yes	
		Open	Yes	
		Close	Yes	
		No disc	Yes	
		Reading	Yes	
		Play	Yes	
		Still/Pause	Yes	
		Stop	Yes	
		Prohibit Mark	Yes	
		Step	Yes	
		Skip+	Yes	
		Skip-	Yes	
		Random	Yes	
		Repeat	Yes	
		A-B Repeat	Yes	
		Slow+ ##	Yes	
		Slow- ##	No	
		Search+ ##	Yes	
		Search- ##	Yes	
		Resume	Yes	
		Title No.	Yes	
		Chapter No.	Yes	
		Track No.	Yes	
		Time	Yes	
		Sub Title No.	Yes	
		Angle No.	Yes	
		Audio No.	Yes	
		Zoom	Yes	
		Enter	Yes	
		Exit	Yes	
		Bit Rate	Yes	
		Memory	Yes	
		Screen Saver	Yes	
		E.A.M	Yes	

## GENERAL SPECIFICATIONS

	On Screen Display(VCR)	Menu	Yes Character
		Menu Type	
		ATS	No
		Timer Rec Set	Yes
		VCR Extension	Yes
		Auto Repeat On/Off	Yes
		Scene Repeat	Yes
		Audio Dubbing	No
		VCR Set-Up	Yes
		NICAM Auto/Off	Yes
		Audio Mix On/Off	Yes
		Color System	Yes
		Sharpness	Yes
		BBE On/Off	No
		CH Set-Up	Yes
		CH Tuning	Yes
		Auto Tuning	Yes
		CH Mapping	Yes
		Guide CH Set	No
		Pin Code Registration	No
		System Set-Up	Yes
		Clock Set	Yes (Calendar 24H)
		Language	Yes
		AV2 DEC/AV	Yes
		G-CODE(or SHOWVIEW or PLUSCODE)No. Entry	Yes
		NICAM 1/2,NICAM Off,Audio Output	Yes
		Stereo,Audio Output,Bilingual	Yes
		Play/Stop/FF/Rew/Rec/OTR/T-Rec/Pause/Eject/Tape In (Symbol Mark)	Yes
		Others	
		CH/AV	Yes
		Clock/Date	Yes
		Repeat	No
		Pin Code	No
		Tape Counter	Yes
		Index	Yes
		Hotel Lock	No
		Tape Speed	Yes
		Manual Tracking (Bar Setting)	Yes
		Hi-Fi	Yes
		S-Repeat/SR-R/SR-Play	Yes
		VPS	No
		PDC	Yes
		TEST Signal	No
G-11	OSD Language	DVD OSD	Eng Ger Fre
		VCR OSD	Eng Ger Fre
G-12	Clock,Timer and Timer Back-up	Calendar	1990/1/1 - 2081/12/31
		Timer Events	8 Program/ 1 Month
		One Touch Recording Max Time	SP:5Hours LP:10 Hours
		OTPB Valid Time	No
		Timer Back-up (at Power Off Mode)	30 Min
G-13	Display	DISPLAY	Yes
		DISPLAY type	LED Module (Green, "Rec" &Timer symbol = Red)
		Clock/Counter,CH,Timer Rec,OTR, Play Rec,FF(Cue),Rew(Rev),Stop,ATR,Eject	No
		VCR	Yes
		DVD	Yes
		CD	Yes
		Clock	Yes (24h)
		AM	No
		PM	No
		Counter	
		VCR	Yes (hour:min)
		DVD	Yes (hour:min)
		CD	Yes (min:sec)
		Counter Remain	No
		Play	Yes
		Stop	No
		Rec	Yes
		FF / Cue	No
		REW /Review	No
		Pause/Still	Yes
		OTR	No
		T-Rec	Yes
		Chapter	No
		TITLE	No
		TRACK	Yes
		Repeat	No
		Hi-Fi	No
		SP	No
		LP	No
		SLP	No
		CH	Yes
		RF Output CH	No
		Auto Tuning	Yes
		Eject	Yes
		Tape In	Yes
		Remocon Custom Code	Yes

## GENERAL SPECIFICATIONS

G-14	Remote Control	Unit	RC-FO	
		Glow in Dark Remocon	Yes	
		Format	JVC	
		Custom Code	43,53(DVD,VCR), 03(TV)	
		Power Source	Voltage(D.C) UM size x pcs	3V UM-3 x 2 pcs
		Total Keys		50 Key
		Keys	Power	Yes
			VCR	Yes
			DVD	Yes
			1	Yes
			2	Yes
			3	Yes
			4	Yes
			5	Yes
			6	Yes
			7	Yes
			8	Yes
			9	Yes
			0/AV	Yes
			DVD MENU	Yes
			MEMORY	Yes
			RETURN	Yes
			OPEN/CLOSE	Yes
			CLOCK / COUNTER	Yes
			SUB TITLE/ATR	Yes
			ANGLE/COUNTER RESET	Yes
			ZERO RETURN	Yes
			PLAY MODE/SPEED	Yes
			ZOOM	Yes
			TITLE	Yes
			REPEAT A-B	Yes
			PROGRAM/G-CODE	Yes
			T-REC	Yes
			TV Vol.+	Yes
			TV Vol.-	Yes
			TV/VCR	Yes
			TV Input	Yes
			FF(Cue)/SEARCH+	Yes
			REW(Review)/SEARCH-	Yes
			PLAY	Yes
			STOP	Yes
	PAUSE/STILL	Yes		
	REC/OTR	Yes		
	SKIP+ / INDEX+	Yes		
	SKIP- / INDEX-	Yes		
	UP/CH+	Yes		
	DOWN/CH-	Yes		
	LEFT/ SET- / TRACKING-	Yes		
	RIGHT/ SET+ / TRACKING+	Yes		
	SELECT/ENTER	Yes		
	SET UP MENU/ VCR MENU	Yes		
	CLEAR/CANCEL	Yes		
	DISPLAY/CALL	Yes		
	AUDIO / AUDIO SELECT	Yes		
	SLOW(Forward)	Yes		
	CM SKIP(Skip search)	Yes		
	Slide SW	TV / VCR&DVD Select		
G-15	Features (DVD)	Auto Power Off	No	
		Parental Lock	Yes	
		Video CD Playback	Yes	
		MP3 Playback	Yes	
		Digital Out	Dolby Digital	Yes
			PCM	Yes
			DTS	Yes
			MPEG1,MPEG2	Yes
		Down Mix Out	(Dolby Digital, MPEG1,MPEG2)	Yes
		Self Diagnostic		No
		Spatializer (N-2-2)		Yes
		Screen Saver		Yes
		Frame Advance		Yes
One Touch Replay (10 Secreverse)		No		



## GENERAL SPECIFICATIONS

<b>Features (VCR)</b>	Auto Head Cleaning	No
	Auto Tracking	Yes
	Index Search	Yes
	HQ (VHS Standard High Quality)	Yes
	Auto Power On, Auto Play, Auto Rewind, Auto Eject	Yes
	Auto Repeat	Yes
	Auto Power Off	No
	VIDEO PLUS+(SHOWVIEW,G-CODE)	Yes
	Auto Tuning/Auto Clock/Auto Guide ch	Yes
	Auto Set Up (CH Auto Set-Up/Auto Clock)	No
	PDC	Yes
	VPS	No
	Reverse Slow	No
	One Touch Playback	No
	Picture Control(Sharpness)	Yes
	Channel Lock	No
	Hotel Lock	No
	Anti Theft	No
	Audio Dubbing	No
	Remote Control Code 1/2	Yes
	BBE Audio	No
	Rec END Search	No
	SQP(B(PAL SP MODE))	Yes
	CATV	Yes
	CM Skip(30sec x 6 Times)	Yes
	Copy (Disc to Tape)	Yes (by Conditioning)
<b>G-16 Accessories</b>	Owner's Manual	Yes
	Language w/Guarantee Card	French No
	Remote Control Unit	Yes
	Dew Cation Sheet	No
	Battery	Yes
	UM size x pcs	UM-3 x 2 pcs
	Tape Rewinder	No
	Safety Tip	No
	Toll Free Insert Sheet	No
	Quick Set-Up Sheet	No
	Information Sheet	No
	75 Ohm Coaxial Cable	Yes (0.9m)
	type	Single shield
	U/V Mixer	No
	DC Car Cord (Center+)	No
	Guarantee Card	Yes
	Warning Sheet	No
	Circuit Diagram	No
	Antenna Change Plug	No
	Service Facility List	No
	Important Safeguard	No
	Dew/AHC Caution Sheet	No
	AC Plug Adapter	No
	AC Cord	No
	AV Cord (2Pin-1Pin)	No
	Registration Card	No
21pin Cable	Yes	
300 ohm to 75 ohm Antenna Adapter	No	

## GENERAL SPECIFICATIONS

G-17	Interface	Switch	Front	Power	Yes	
				Play	Yes	
				Eject (VCR)	Yes	
				Stop	Yes	
				Rec/OTR	Yes	
				Open/Close (DVD)	Yes	
				CH +	Yes	
				CH -	Yes	
				FF/ Search(>>)	Yes	
				Rew/Search(<<)	Yes	
				Still/Pause	No	
				Shuttle(Search/REV/FWD)	No	
				DVD/VCR	Yes	
				Input Select	No	
				Main Power SW	No	
		Rear	Attenuator	No		
			Video/RGB Selector	No		
			RF Out(Slide SW)	No		
			Main Power SW	No		
		Volume	Phones Volume	No		
			Mic Volume	No		
			Echo Volume	No		
			Rec/OTR	No		
		Terminals	Front	Video In	RCA x 1(Yellow)	
				Audio In	RCA x 2(Stereo, White/Red)	
			Rear	Video Output	No	
				Audio Output	RCA x 2(Stereo, White/Red) Coaxial x 1 (Digital Audio,DVD Signal Only)	
				Video Input	No	
				Audio Input	No	
				Optical Digital Audio Out (Option)	Yes	
				Euro Scart	2SCART	
			S-Video Output	Yes (DVD Signal Only)		
			Ext Speaker	No		
			VHF/UHF Antenna Input/Output	DIN Type (France)		
			Indicator	LED	AC Inlet	No
					Power	No
					Rec	No
		T-Rec			No	
		TV/VCR			No	
		DVD			Yes (GREEN)	
VCR	Yes (GREEN)					
Surround	No					
Level Meter	No					
G-18	Set Size	Approx.	W x D x H (mm)	430 x 310.5 x 99		
G-19	Weight	Net (Approx.)		4.5 kg( 9.9lbs)		
		Gross (Approx.)		5.5 kg( 12.1lbs)		
G-20	Carton	Master Carton		No		
			Content	--- Sets		
			Material	--- / ---		
			Dimensions W x D x H(mm)	---		
			Description of Origin	---		
		Gift Box		Yes		
			Material	Single/Brown		
			W/Color Photo Label	No		
			Dimensions W x D x H(mm)	500 x 430 x 180		
			Pulp Package	No		
			Design	As Per BUYER 's		
			Description of Origin	No		
			Drop Test	Natural Dropping At	1 Corner / 3 Edges / 6 Surfaces	
			Height (cm)		80 cm	
Container Stuffing		1,623 Sets/40' container				
G-21	Cabinet Material	Cabinet Front		PS 94HB		





# JVC

VICTOR COMPANY OF JAPAN, LIMITED

HOME AV NETWORK BUSINESS UNIT. 12,3-chome,Moriya-cho,Kanagawa-ku,Yokohama,Kanagawa-prefecture,221-8528,Japan



Printed in Japan  
0208 VP

Note : The Parts Number, value and rated voltage etc. in the Schematic Diagram are for references only. When replacing the parts, refer to the Parts List.

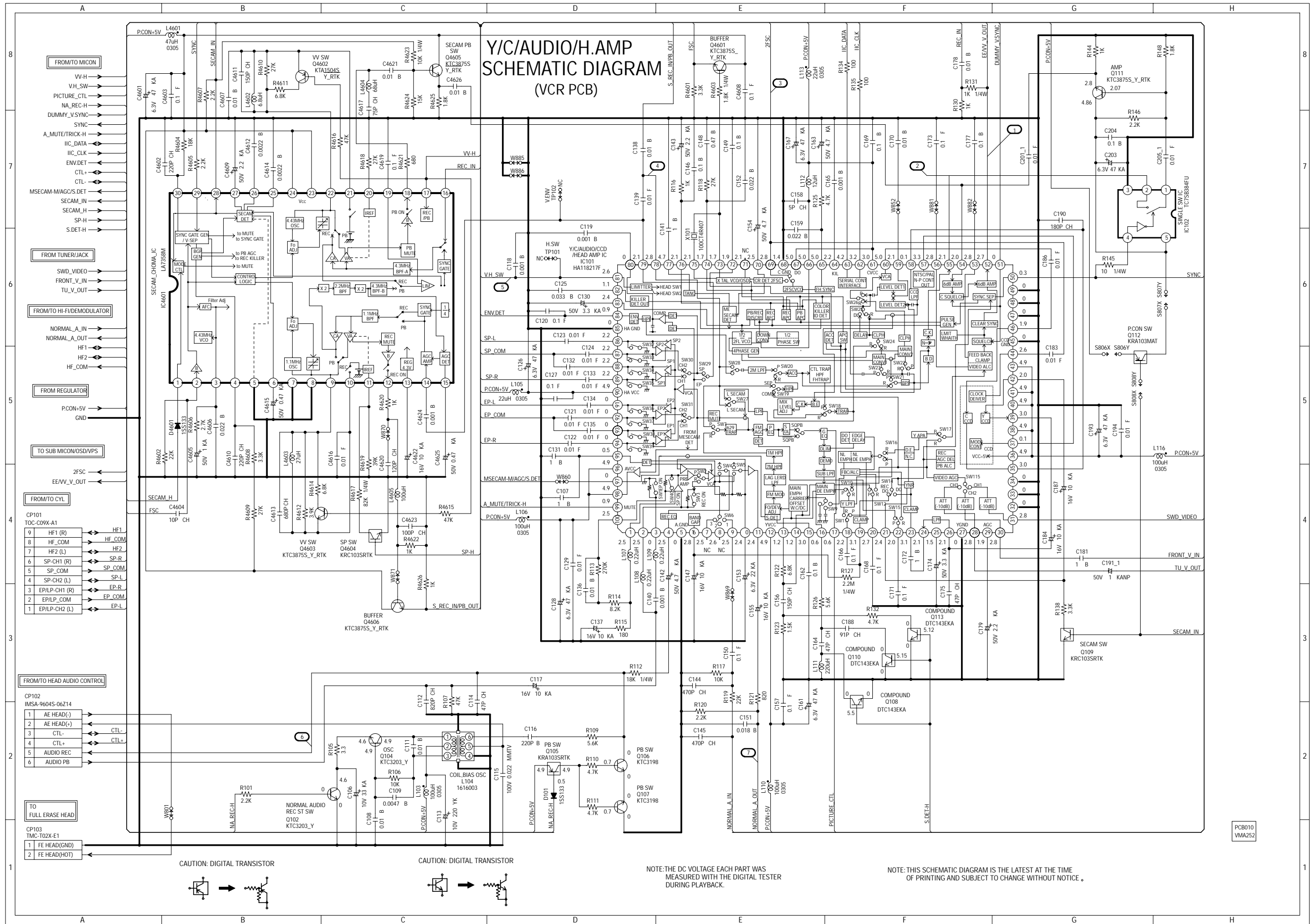

Note : The Parts Number, value and rated voltage etc. in the Schematic Diagram are for references only. When replacing the parts, refer to the Parts List.

# MICON SCHEMATIC DIAGRAM (VCR PCB)

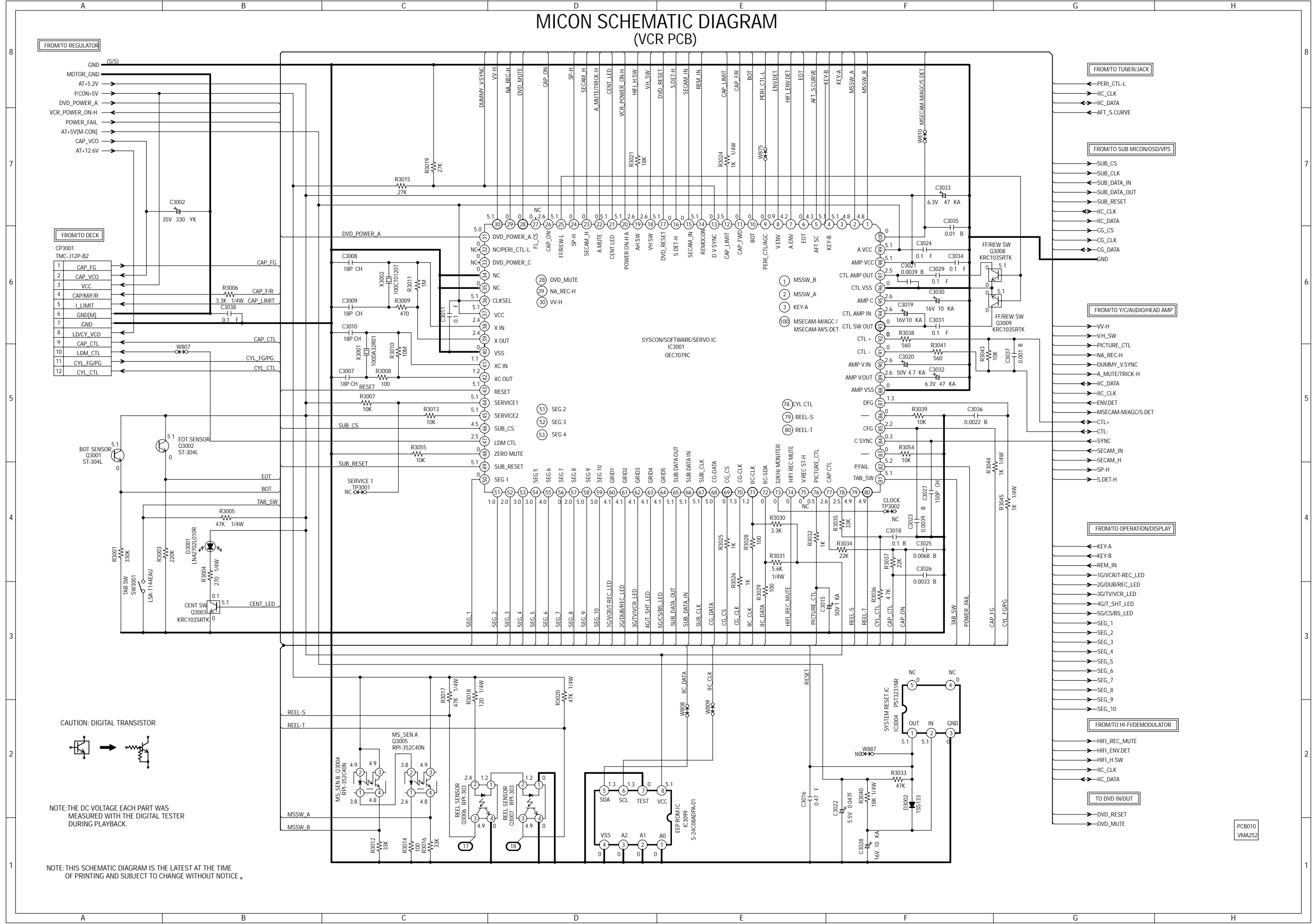

Note : The Parts Number, value and rated voltage etc. in the Schematic Diagram are for references only. When replacing the parts, refer to the Parts List.

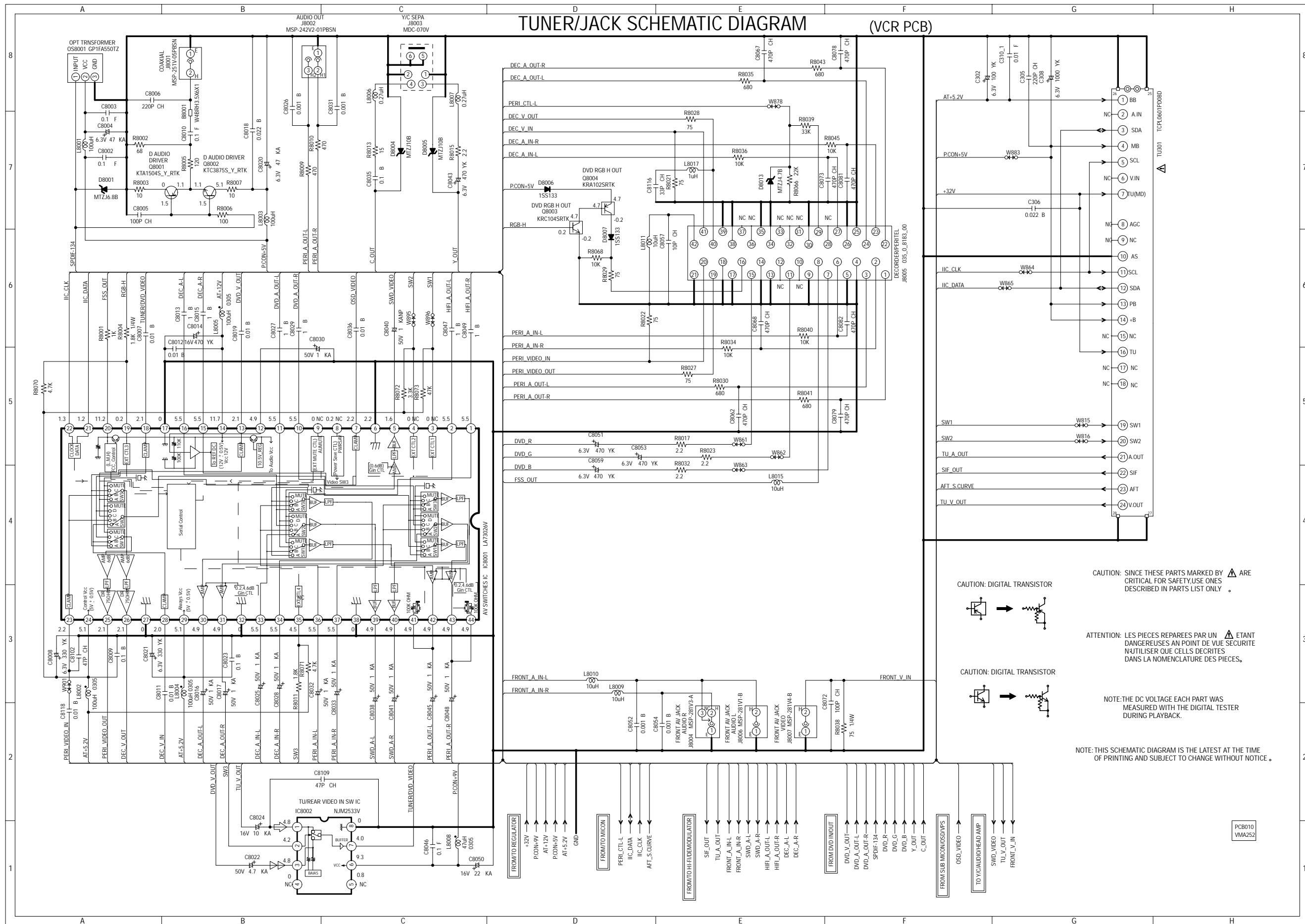

CAUTION: DIGITAL TRANSISTOR

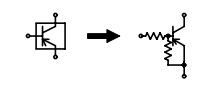

CAUTION: DIGITAL TRANSISTOR

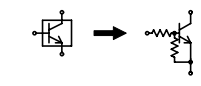

CAUTION: SINCE THESE PARTS MARKED BY ARE CRITICAL FOR SAFETY, USE ONES DESCRIBED IN PARTS LIST ONLY.

ATTENTION: LES PIÈCES RÉPARÉES PAR UN ÉTANT DANGEREUSES AN POINT DE VUE SÉCURITÉ N'UTILISER QUE CELLES DÉCRITES DANS LA NOMENCLATURE DES PIÈCES.

NOTE: THE DC VOLTAGE EACH PART WAS MEASURED WITH THE DIGITAL TESTER DURING PLAYBACK.

NOTE: THIS SCHEMATIC DIAGRAM IS THE LATEST AT THE TIME OF PRINTING AND SUBJECT TO CHANGE WITHOUT NOTICE.

Note : The Parts Number, value and rated voltage etc. in the Schematic Diagram are for references only. When replacing the parts, refer to the Parts List.

## SUB MICON/OSD/VPS SCHEMATIC DIAGRAM (VCR PCB)

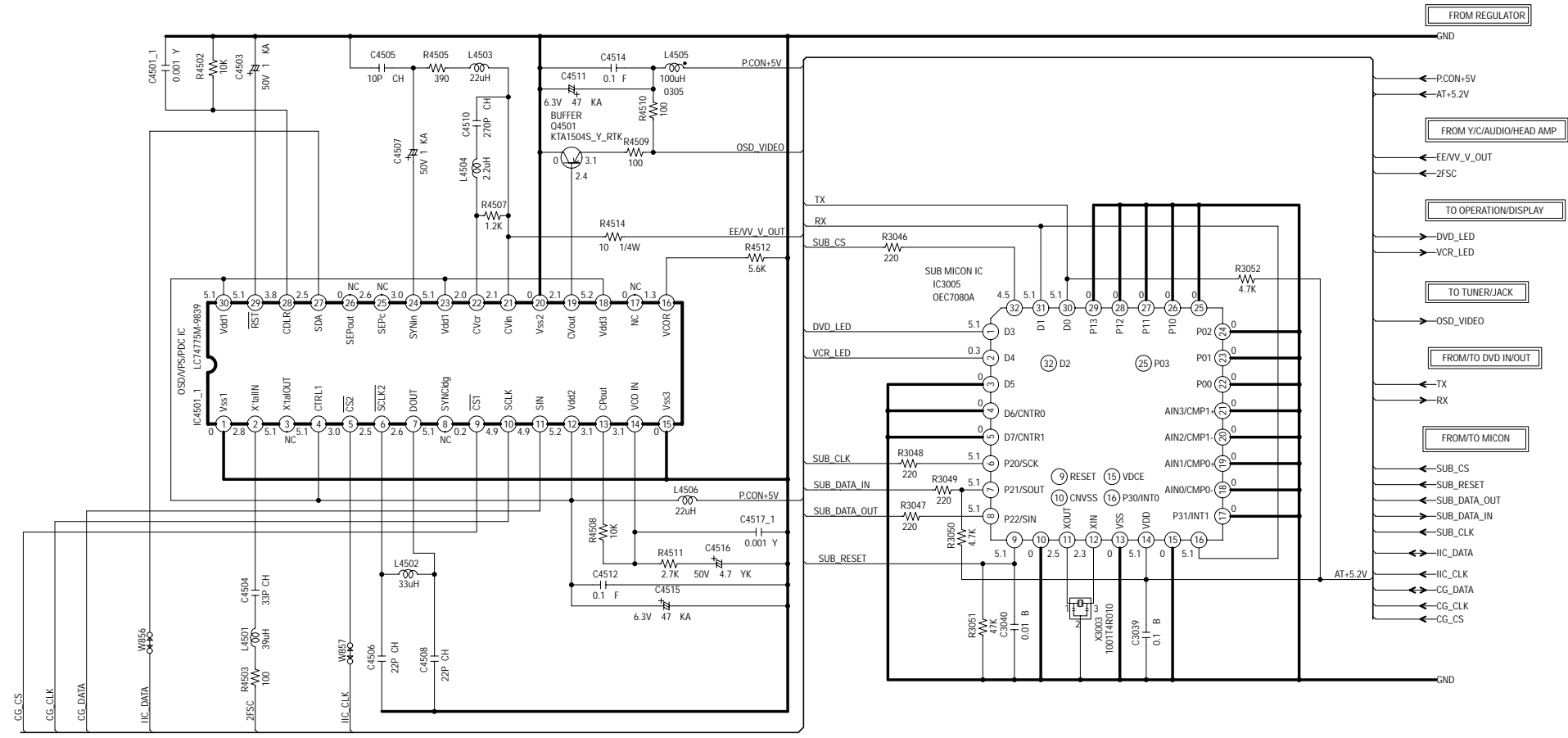

NOTE: THE DC VOLTAGE EACH PART WAS MEASURED WITH THE DIGITAL TESTER DURING PLAYBACK.

NOTE: THIS SCHEMATIC DIAGRAM IS THE LATEST AT THE TIME OF PRINTING AND SUBJECT TO CHANGE WITHOUT NOTICE.

PCB010  
VMA252





PRINTED CIRCUIT BOARDS  
VCR (CHIP MOUNTED PARTS)  
SOLDER SIDE

<VCR> VMB252A

REF.NO.	LOCATION	REF.NO.	LOCATION	REF.NO.	LOCATION	REF.NO.	LOCATION
IC102	13J	Q8001	2H	R3013	13C	R8054	8A
IC701	9M	Q8002	2G	R3014	17D	R8055	7B
IC801	16M	Q8003	3M	R3015	12I	R8056	7A
IC3001	14E	Q8004	3N	R3016	17D	R8057	7A
IC3004	12C	Q8012	7D	R3017	16D	R8058	7B
IC3005	14C	Q8013	7D	R3018	16L	R8059	7A
IC3099	19H	Q8014	6G	R3019	12I	R8060	7A
IC4501_1	17J	Q8015	6G	R3020	16C	R8061	7B
IC4601	13M			R3021	13F	R8062	7B
IC8001	4I	<b>RESISTOR</b>		R3024	11D	R8063	7C
IC8002	5M	R101	9F	R3025	16C	R8066	3M
IC8004	7B	R105	9F	R3026	16C	R8067	10B
		R106	9G	R3028	18F	R8068	3M
<b>COIL</b>		R107	7I	R3029	18E	R8070	5I
L103	7H	R109	9G	R3030	18E	R8071	3J
L104	9G	R110	8H	R3031	18E	R8072	5H
L105	6J	R111	8H	R3032	15D	R8073	6D
L106	7J	R112	7H	R3033	12E	R8076	6H
L107	8J	R113	8J	R3034	16C	R8077	7D
L108	8J	R114	8J	R3035	16C	R8082	6D
L109	8I	R115	8I	R3036	16C		
L110	9C	R116	11L	R3037	16C	<b>SWITCH</b>	
L111	9H	R117	7I	R3038	15F	SW3001	19N
L112	11J	R118	10L	R3039	15E	SW651	19P
L113	12J	R119	7K	R3040	12D	SW652	19P
L116	11I	R120	7L	R3041	15F	SW653	19H
L701	7L	R121	7K	R3043	11E	SW654	19I
L702	7L	R122	8I	R3044	17D	SW655	19K
L802	14N	R123	8H	R3045	17D		
L4501	16J	R125	11K	R3046	13C	<b>TEST POINT</b>	
L4502	17I	R126	9H	R3047	13B	TP101	14O
L4503	17K	R127	9I	R3048	13B	TP102	13O
L4504	17K	R130	12L	R3049	14B	TP701	14O
L4505	18J	R131	12L	R3050	14C	TP3001	5F
L4506	14J	R132	8H	R3051	14C	TP3002	18F
L4601	14K	R134	12K	R3052	13C		
L4602	13K	R135	12K	R3054	16E	<b>OTHER</b>	
L4603	11M	R138	10H	R3055	12B	R8005	6C
L4604	13L	R144	13J	R4502	17K	J8001	1G
L4605	12M	R145	13J	R4503	16I	J8002	1H
L8001	1E	R146	13J	R4505	17I	J8003	1J
L8002	5K	R148	13K	R4507	17K	J8004	20M
L8003	1E	R651	19L	R4508	17I	J8005	1M
L8004	5J	R652	19E	R4509	18K	J8006	20N
L8005	5H	R654	17A	R4510	18K	J8007	20O
L8006	1I	R655	19H	R4511	17I	OS651	20F
L8007	2I	R656	19B	R4512	18J	OS80501	1E
L8008	5N	R657	19H	R4514	17K	S806X	13J
L8009	19M	R658	17B	R4601	12L	S806Y	5O
L8010	19N	R659	19B	R4602	13N	S807X	6O
L8011	3N	R660	19B	R4603	11L	S807Y	13C
L8015	3L	R661	19H	R4604	14M	S808X	13I
L8017	2N	R662	16B	R4605	14K	S808Y	5O
		R663	19B	R4606	13N	TU301	19P
<b>TRANSISTOR</b>		R664	19C	R4607	14M	V61	10K
Q102	9F	R665	19C	R4608	13N	X101	13D
Q104	8F	R666	14G	R4609	13N	X3001	13D
Q105	9G	R667	14G	R4610	13K	X3002	13D
Q106	8H	R668	19C	R4611	13K	X3003	14B
Q107	8H	R669	19C	R4612	13M	X300X	15P
Q108	9H	R670	16B	R4614	11M		
Q109	10H	R674	19D	R4615	12L		
Q110	9H	R675	19D	R4616	13L		
Q111	13J	R678	17B	R4617	12M		
Q112	5O	R701	9N	R4618	12L		
Q113	9H	R702	17H	R4619	11M		
Q651	13A	R705	16L	R4620	12M		
Q653	18A	R706	9L	R4621	12L		
Q654	18A	R707	9L	R4622	11L		
Q655	17B	R708	8L	R4623	14K		
Q656	17B	R709	8M	R4624	14K		
Q657	18B	R710	9N	R4625	14K		
Q658	18B	R711	8M	R4626	12M		
Q659	19B	R712	9N	R8001	5H		
Q660	18B	R713	8N	R8002	1E		
Q661	18B	R714	10N	R8003	2H		
Q662	19C	R715	10O	R8004	1E		
Q663	18C	R716	9N	R8005	2G		
Q664	18C	R717	9N	R8006	2G		
Q665	19D	R718	9O	R8007	2G		
Q666	19D	R719	9O	R8008	2H		
Q667	18D	R720	9O	R8010	2H		
Q1701	3B	R721	9O	R8011	4K		
Q1702	2C	R814	15N	R8013	1I		
Q1703	2C	R1703	1B	R8015	2I		
Q1705	4E	R1706	4E	R8017	2J		
Q1706	4E	R1707	4E	R8021	1C		
Q1707	4E	R1708	1C	R8022	1N		
Q1708	4D	R1709	1C	R8023	1I		
Q1709	4D	R1711	4E	R8027	1O		
Q1711	4D	R1712	3C	R8028	2O		
Q1712	3D	R1713	3D	R8029	1N		
Q1713	2D	R1714	4E	R8030	2K		
Q1714	2C	R1715	4E	R8032	2K		
Q3001	13A	R1716	4E	R8034	3K		
Q3002	13P	R1717	4D	R8035	3L		
Q3003	13I	R1720	3D	R8036	3L		
Q3004	17D	R1721	2D	R8038	19C		
Q3005	16D	R1722	4B	R8039	2M		
Q3006	16L	R3001	11A	R8040	7L		
Q3007	16F	R3003	13P	R8041	1K		
Q3008	15G	R3004	14I	R8043	3L		
Q3009	15G	R3005	18E	R8045	3L		
Q4501	18K	R3006	11D	R8047	9B		
Q4601	12L	R3007	12C	R8048	9B		
Q4602	13K	R3008	13D	R8049	8B		
Q4603	11M	R3009	13D	R8050	8A		
Q4604	13N	R3010	14D	R8051	8A		
Q4605	13K	R3011	13D	R8052	8B		
Q4606	12M	R3012	17D	R8053	7B		

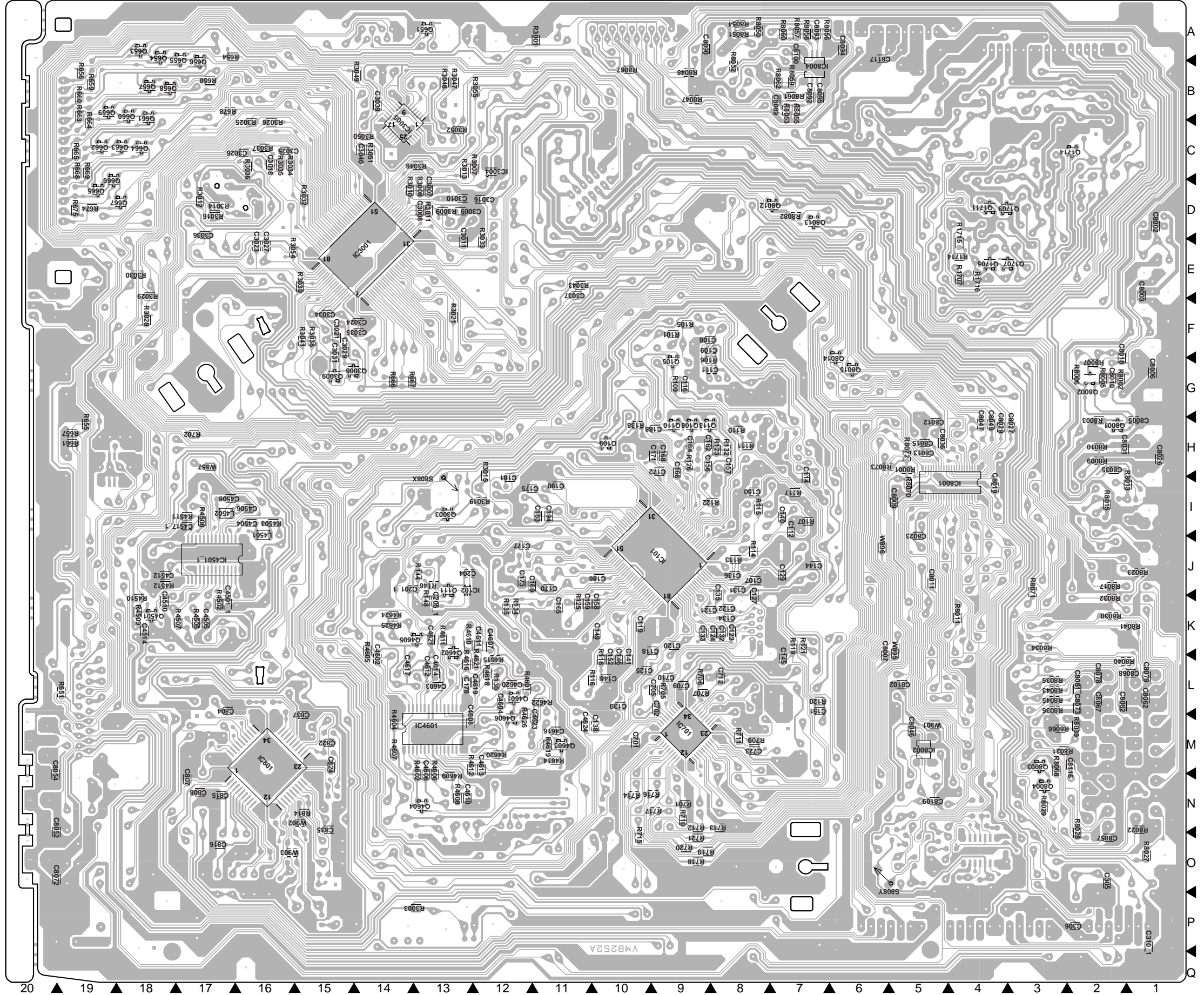

# PARTS LIST

## SAFETY PRECAUTION

Parts identified by the  $\triangle$  symbol are critical for safety. Replace only with specified part numbers.

### 1. PACKING AND ACCESSORY ASSEMBLY <M1>

The instruction manual to be provided with this product will differ according to the destination.

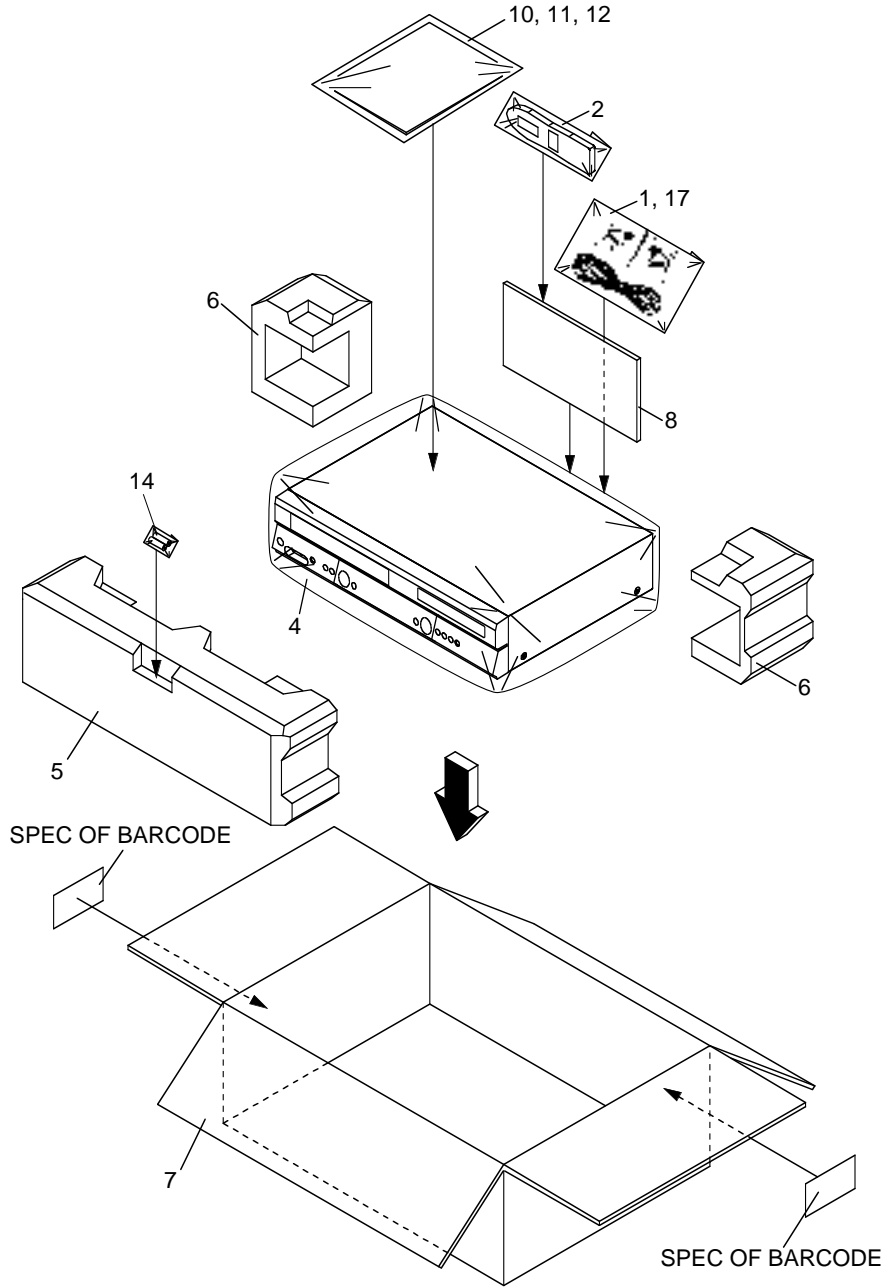

# $\triangle$	REF No.	PART No.	PART NAME, DESCRIPTION
*****			
<b>PACKING AND ACCESSORY ASSEMBLY &lt;M1&gt;</b>			
1	X-06CDL02004		CABLE, COAXIAL 75 $\Omega$ CDL02003
2	X-076D0F0010		REMOTE CONTROL
4	X-791UHA0014		GIFT SHEET
5	X-792UHAA026		PACKAGE, FRONT
6	X-792UHAA030		PACKAGE, BACK

# $\triangle$	REF No.	PART No.	PART NAME, DESCRIPTION
7	X-793UCDA995		GIFT BOX
8	X-795UCA0021		PAD, DVD/VR
10	X-JB5XD200		POLYBAG, INSTRUCTION (RED CAUTION)
$\triangle$ 11	X-J2A77901		INST. BOOK (FR) LPT0717-001A
12	X-J2A77512		GUARANTEE CARD, EURO
14	—		BATTERY, X2
17	X-06CDVA5002		CABLE, SCART 21PIN

## 2. ELECTRICAL PARTS LIST

#  $\Delta$  REF No. PART No. PART NAME, DESCRIPTION  
 \*\*\*\*\*

### VCR BOARD ASSEMBLY <03>

**Note**  
 When replacing parts in repair, use chip parts although Melf parts may be used at the time of factory shipment.

PCB010	X-A2A779D010B	PCB ASSY	
R101	NRSA02J-222X	MG RESISTOR	2.2K $\Omega$ ,1/10W
R105	NRSA02J-3R3X	MG RESISTOR	3.3 $\Omega$ ,1/10W
R106	NRSA02J-103X	MG RESISTOR	10K $\Omega$ ,1/10W
R107	NRSA02J-473X	MG RESISTOR	47K $\Omega$ ,1/10W
R109	NRSA02J-562X	MG RESISTOR	5.6K $\Omega$ ,1/10W
R110	NRSA02J-472X	MG RESISTOR	4.7K $\Omega$ ,1/10W
R111	NRSA02J-472X	MG RESISTOR	4.7K $\Omega$ ,1/10W
R112	QRE141J-183Y	RESISTOR	18K $\Omega$ ,1/4W
R113	NRSA02J-274X	MG RESISTOR	270K $\Omega$ ,1/10W
R114	NRSA02J-822X	MG RESISTOR	8.2K $\Omega$ ,1/10W
R115	NRSA02J-181X	MG RESISTOR	180 $\Omega$ ,1/10W
R116	NRSA02J-102X	MG RESISTOR	1K $\Omega$ ,1/10W
R117	NRSA02J-103X	MG RESISTOR	10K $\Omega$ ,1/10W
R118	NRSA02J-273X	MG RESISTOR	27K $\Omega$ ,1/10W
R119	NRSA02J-223X	MG RESISTOR	22K $\Omega$ ,1/10W
R120	NRSA02J-222X	MG RESISTOR	2.2K $\Omega$ ,1/10W
R121	NRSA02J-821X	MG RESISTOR	820 $\Omega$ ,1/10W
R122	NRSA02J-682X	MG RESISTOR	6.8K $\Omega$ ,1/10W
R123	NRSA02J-152X	MG RESISTOR	1.5K $\Omega$ ,1/10W
R125	NRSA02J-472X	MG RESISTOR	4.7K $\Omega$ ,1/10W
R126	NRSA02J-562X	MG RESISTOR	5.6K $\Omega$ ,1/10W
R127	QRE141J-225Y	RESISTOR	2.2M $\Omega$ ,1/4W
R130	NRSA02J-102X	MG RESISTOR	1K $\Omega$ ,1/10W
R131	QRE141J-102Y	RESISTOR	1K $\Omega$ ,1/4W
R132	NRSA02J-472X	MG RESISTOR	4.7K $\Omega$ ,1/10W
R134	NRSA02J-101X	MG RESISTOR	100 $\Omega$ ,1/10W
R135	NRSA02J-101X	MG RESISTOR	100 $\Omega$ ,1/10W
R138	NRSA02J-332X	MG RESISTOR	3.3K $\Omega$ ,1/10W
R144	NRSA02J-102X	MG RESISTOR	1K $\Omega$ ,1/10W
R145	QRE141J-100Y	RESISTOR	10 $\Omega$ ,1/4W
R146	NRSA02J-222X	MG RESISTOR	2.2K $\Omega$ ,1/10W
R148	NRSA02J-182X	MG RESISTOR	1.8K $\Omega$ ,1/10W
R651	NRSA02J-331X	MG RESISTOR	330 $\Omega$ ,1/10W
R652	NRSA02J-101X	MG RESISTOR	100 $\Omega$ ,1/4W
R654	NRSA02J-821X	MG RESISTOR	820 $\Omega$ ,1/10W
R655	NRSA02J-272X	MG RESISTOR	2.7K $\Omega$ ,1/10W
R656	NRSA02J-181X	MG RESISTOR	180 $\Omega$ ,1/10W
R657	NRSA02J-182X	MG RESISTOR	1.8K $\Omega$ ,1/10W
R658	NRSA02J-821X	MG RESISTOR	820 $\Omega$ ,1/10W
R659	NRSA02J-181X	MG RESISTOR	180 $\Omega$ ,1/10W
R660	NRSA02J-181X	MG RESISTOR	180 $\Omega$ ,1/10W
R661	NRSA02J-152X	MG RESISTOR	1.5K $\Omega$ ,1/10W
R662	QRE141J-821Y	RESISTOR	820 $\Omega$ ,1/4W
R663	NRSA02J-181X	MG RESISTOR	180 $\Omega$ ,1/10W
R664	NRSA02J-181X	MG RESISTOR	180 $\Omega$ ,1/10W
R665	NRSA02J-181X	MG RESISTOR	180 $\Omega$ ,1/10W
R666	NRSA02J-103X	MG RESISTOR	10K $\Omega$ ,1/10W
R667	NRSA02J-103X	MG RESISTOR	10K $\Omega$ ,1/10W
R668	NRSA02J-181X	MG RESISTOR	180 $\Omega$ ,1/10W
R669	NRSA02J-181X	MG RESISTOR	180 $\Omega$ ,1/10W
R670	QRE141J-821Y	RESISTOR	820 $\Omega$ ,1/4W
R674	NRSA02J-181X	MG RESISTOR	180 $\Omega$ ,1/10W

# $\Delta$ REF No.	PART No.	PART NAME, DESCRIPTION	
R675	NRSA02J-181X	MG RESISTOR	180 $\Omega$ ,1/10W
R678	NRSA02J-821X	MG RESISTOR	820 $\Omega$ ,1/10W
R701	NRSA02J-184X	MG RESISTOR	180K $\Omega$ ,1/10W
R702	NRSA02J-103X	MG RESISTOR	10K $\Omega$ ,1/10W
R705	NRSA02J-471X	MG RESISTOR	470 $\Omega$ ,1/10W
R706	NRSA02J-333X	MG RESISTOR	33K $\Omega$ ,1/10W
R707	NRSA02J-272X	MG RESISTOR	2.7K $\Omega$ ,1/10W
R708	X-R4X5T6393F	OM RESISTOR	39K $\Omega$ ,1/6W
R709	NRSA02J-272X	MG RESISTOR	2.7K $\Omega$ ,1/10W
R710	NRSA02J-473X	MG RESISTOR	47K $\Omega$ ,1/10W
R711	NRSA02J-333X	MG RESISTOR	33K $\Omega$ ,1/10W
R712	NRSA02J-473X	MG RESISTOR	47K $\Omega$ ,1/10W
R713	NRSA02J-184X	MG RESISTOR	180K $\Omega$ ,1/10W
R714	NRSA02J-473X	MG RESISTOR	47K $\Omega$ ,1/10W
R715	NRSA02J-473X	MG RESISTOR	47K $\Omega$ ,1/10W
R716	NRSA02J-473X	MG RESISTOR	47K $\Omega$ ,1/10W
R717	NRSA02J-473X	MG RESISTOR	47K $\Omega$ ,1/10W
R718	NRSA02J-103X	MG RESISTOR	10K $\Omega$ ,1/10W
R719	NRSA02J-103X	MG RESISTOR	10K $\Omega$ ,1/10W
R720	NRSA02J-103X	MG RESISTOR	10K $\Omega$ ,1/10W
R721	NRSA02J-103X	MG RESISTOR	10K $\Omega$ ,1/10W
R814	NRSA02J-822X	MG RESISTOR	8.2K $\Omega$ ,1/10W
R1703	QRE141J-103Y	RESISTOR	10K $\Omega$ ,1/4W
R1706	QRE141J-392Y	RESISTOR	3.9K $\Omega$ ,1/4W
R1707	NRSA02J-222X	MG RESISTOR	2.2K $\Omega$ ,1/10W
R1708	QRE121J-181Y	RESISTOR	180 $\Omega$ ,1/2W
R1709	QRE141J-391Y	RESISTOR	390 $\Omega$ ,1/4W
R1711	NRSA02J-101X	MG RESISTOR	100 $\Omega$ ,1/4W
R1712	QRE141J-221Y	RESISTOR	220 $\Omega$ ,1/4W
R1713	QRE141J-103Y	RESISTOR	10K $\Omega$ ,1/4W
R1714	NRSA02J-101X	MG RESISTOR	100 $\Omega$ ,1/10W
R1715	NRSA02F-821X	MG RESISTOR	820 $\Omega$ ,1/10W
R1716	NRSA02F-122X	MG RESISTOR	1.2K $\Omega$ ,1/10W
R1717	QRE141J-223Y	RESISTOR	22K $\Omega$ ,1/4W
R1720	QRE141J-561Y	RESISTOR	560 $\Omega$ ,1/4W
R1721	QRE141J-102Y	RESISTOR	1K $\Omega$ ,1/4W
R1722	QRE121J-222Y	RESISTOR	2.2K $\Omega$ ,1/2W
R3001	NRSA02J-334X	MG RESISTOR	330K $\Omega$ ,1/10W
R3003	NRSA02J-224X	MG RESISTOR	220K $\Omega$ ,1/10W
R3004	QRE141J-271Y	RESISTOR	270 $\Omega$ ,1/4W
R3005	QRE141J-473Y	RESISTOR	47K $\Omega$ ,1/4W
R3006	QRE141J-332Y	RESISTOR	3.3K $\Omega$ ,1/4W
R3007	NRSA02J-103X	MG RESISTOR	10K $\Omega$ ,1/10W
R3008	NRSA02J-101X	MG RESISTOR	100 $\Omega$ ,1/10W
R3009	NRSA02J-471X	MG RESISTOR	470 $\Omega$ ,1/10W
R3010	NRSA02J-106X	MG RESISTOR	10M $\Omega$ ,1/10W
R3011	NRSA02J-105X	MG RESISTOR	1M $\Omega$ ,1/10W
R3012	NRSA02J-333X	MG RESISTOR	33K $\Omega$ ,1/10W
R3013	NRSA02J-103X	MG RESISTOR	10K $\Omega$ ,1/10W
R3014	NRSA02J-101X	MG RESISTOR	100 $\Omega$ ,1/10W
R3015	NRSA02J-273X	MG RESISTOR	27K $\Omega$ ,1/10W
R3016	NRSA02J-333X	MG RESISTOR	33K $\Omega$ ,1/10W
R3017	QRE141J-473Y	RESISTOR	47K $\Omega$ ,1/4W
R3018	QRE141J-121Y	RESISTOR	120 $\Omega$ ,1/4W
R3019	NRSA02J-273X	MG RESISTOR	27K $\Omega$ ,1/10W
R3020	QRE141J-473Y	RESISTOR	47K $\Omega$ ,1/4W
R3021	NRSA02J-183X	MG RESISTOR	18K $\Omega$ ,1/10W
R3024	QRE141J-102Y	RESISTOR	1K $\Omega$ ,1/4W
R3025	NRSA02J-102X	MG RESISTOR	1K $\Omega$ ,1/10W
R3026	NRSA02J-102X	MG RESISTOR	1K $\Omega$ ,1/10W
R3028	NRSA02J-101X	MG RESISTOR	100 $\Omega$ ,1/10W



#	△ REF No.	PART No.	PART NAME, DESCRIPTION	#	△ REF No.	PART No.	PART NAME, DESCRIPTION
C112		NDC21HJ-821X	CAPACITOR 820pF,50V	C174		X-E50HU53R3M	E CAPACITOR 3.3μF,50V
C113		X-E02LU1221M	E CAPACITOR 220μF,10V	C175		NDC21HJ-470X	CAPACITOR 47pF,50V
C114		NDC21HJ-470X	CAPACITOR 47pF,50V	C177		NCB21EK-104X	CAPACITOR 0.1μF,25V
C115		X-P232T1223J	CAPACITOR 0.022μF,100V	C178		NCB21HK-103X	CAPACITOR 0.01μF,50V
C116		X-CS0KB04H2K	CAPACITOR 220pF,50V	C179		QEKJ1HM-225Z	E CAPACITOR 2.2μF,50V
C117		QEKJ1CM-106Z	E CAPACITOR 10μF,16V	C181		X-CS0RB0216K	CAPACITOR 1μF,16V
C118		NCB21HK-102X	CAPACITOR 0.001μF,50V	C183		NCF21HZ-103X	CAPACITOR 0.01μF,50V
C119		NCB21HK-102X	CAPACITOR 0.001μF,50V	C184		QEKJ1CM-106Z	E CAPACITOR 10μF,16V
C120		NCF21HZ-104X	CAPACITOR 0.1μF,50V	C186		NCF21HZ-103X	CAPACITOR 0.01μF,50V
C121		NCF21HZ-103X	CAPACITOR 0.01μF,50V	C187		QEKJ1CM-106Z	E CAPACITOR 10μF,16V
C122		NCF21HZ-103X	CAPACITOR 0.01μF,50V	C188		NDC21HJ-910X	CAPACITOR 91pF,50V
C123		NCF21HZ-103X	CAPACITOR 0.01μF,50V	C190		NDC21HJ-151X	CAPACITOR 150pF,50V
C124		NCF21HZ-103X	CAPACITOR 0.01μF,50V	C191		X-E00NU5010M	E CAPACITOR 1μF,50V
C125		NCB21HK-333X	CAPACITOR 0.033μF,50V	C193		QEKJ0JM-476Z	E CAPACITOR 47μF,6.3V
C126		QEKJ0JM-476Z	E CAPACITOR 47μF,6.3V	C194		NCF21HZ-103X	CAPACITOR 0.01μF,50V
C127		NCF21HZ-104X	CAPACITOR 0.1μF,50V	C201		X-CS0KF0214Z	CAPACITOR 0.01μF,16V
C128		QEKJ0JM-476Z	E CAPACITOR 47μF,6.3V	C203		QEKJ0JM-476Z	E CAPACITOR 47μF,6.3V
C129		NCF21HZ-103X	CAPACITOR 0.01μF,50V	C204		NCB21EK-104X	CAPACITOR 0.1μF,25V
C130		X-E50HU53R3M	E CAPACITOR 3.3μF,50V	C205		X-CS0KF0214Z	CAPACITOR 0.01μF,16V
C131		X-CS0RB0216K	CAPACITOR 1μF,16V	C302		QETN0JM-107Z	E CAPACITOR 100μF,6.3V
C132		NCF21HZ-103X	CAPACITOR 0.01μF,50V	C305		X-CS0RCH4H2J	CAPACITOR 220pF,50V
C133		NCF21HZ-103X	CAPACITOR 0.01μF,50V	C306		NCB21HK-223X	CAPACITOR 0.022μF,50V
C134		NCF21HZ-103X	CAPACITOR 0.01μF,50V	C308		X-E02LT0102M	E CAPACITOR 1000μF,6.3V
C135		NCF21HZ-103X	CAPACITOR 0.01μF,50V	C310		NCF21HZ-103X	CAPACITOR 0.01μF,50V
C136		NCB21HK-103X	CAPACITOR 0.01μF,50V	C655		QETN0JM-107Z	E CAPACITOR 100μF,6.3V
C137		QEKJ1CM-106Z	E CAPACITOR 10μF,16V	C701		NCF21HZ-104X	CAPACITOR 0.1μF,50V
C138		NCB21HK-103X	CAPACITOR 0.01μF,50V	C702		NCF21HZ-104X	CAPACITOR 0.1μF,50V
C139		NCF21HZ-103X	CAPACITOR 0.01μF,50V	C703		QEKJ0JM-476Z	E CAPACITOR 47μF,6.3V
C140		NCB21HK-102X	CAPACITOR 0.001μF,50V	C705		NCB21HK-103X	CAPACITOR 0.01μF,50V
C141		X-CS0RB0216K	CAPACITOR 1μF,16V	C708		QETN1CM-227Z	E CAPACITOR 220μF,16V
C142		QEKJ1HM-475Z	E CAPACITOR 4.7μF,50V	C709		NCF21HZ-104X	CAPACITOR 0.1μF,50V
C143		QEKJ1HM-225Z	E CAPACITOR 2.2μF,50V	C710		NCF21HZ-104X	CAPACITOR 0.1μF,50V
C144		NDC21HJ-471X	CAPACITOR 470pF,50V	C711		QEKJ1CM-106Z	E CAPACITOR 10μF,16V
C145		NDC21HJ-471X	CAPACITOR 470pF,50V	C712		X-CS0RB04U3K	CAPASITOR 0.0068μF,50V
C146		NCB21EK-104X	CAPACITOR 0.1μF,25V	C713		QEKJ0JM-476Z	E CAPACITOR 47μF,6.3V
C147		QEKJ1CM-106Z	E CAPACITOR 10μF,16V	C714		QEKJ1CM-106Z	E CAPACITOR 10μF,16V
C148		X-CS0RB02Q5K	CAPACITOR 0.47μF,16V	C715		QEKJ1HM-225Z	E CAPACITOR 2.2μF,50V
C149		NCB21EK-104X	CAPACITOR 0.1μF,25V	C716		QEKJ1HM-105Z	E CAPACITOR 1μF,50V
C150		NCF21HZ-104X	CAPACITOR 0.1μF,50V	C717		QEKJ1HM-105Z	E CAPACITOR 1μF,50V
C151		X-CS0RB04G4K	CAPACITOR 0.018μF,50V	C718		QEKJ1CM-106Z	E CAPACITOR 10μF,16V
C152		NCB21HK-223X	CAPACITOR 0.022μF,50V	C719		QEKJ1HM-105Z	E CAPACITOR 1μF,50V
C153		QEKJ0JM-226Z	E CAPACITOR 22μF,6.3V	C720		QEKJ0JM-476Z	E CAPACITOR 47μF,6.3V
C154		QEKJ1HM-475Z	E CAPACITOR 4.7μF,50V	C721		QEKJ1HM-105Z	E CAPACITOR 1μF,50V
C155		QEKJ1CM-106Z	E CAPACITOR 10μF,16V	C722		QEKJ1CM-106Z	E CAPACITOR 10μF,16V
C156		X-CS0RCH4E2J	CAPACITOR 150pF,50V	C723		X-CS0RB04U3K	CAPASITOR 0.0068μF,50V
C157		NCF21HZ-104X	CAPACITOR 0.1μF,50V	C724		QEKJ1CM-106Z	E CAPACITOR 10μF,16V
C158		X-CS0KCH450C	CAPACITOR 5pF,50V	C725		QEKJ1CM-106Z	E CAPACITOR 10μF,16V
C159		NCB21HK-223X	CAPACITOR 0.022μF,50V	C726		QEKJ1HM-105Z	E CAPACITOR 1μF,50V
C161		QEKJ0JM-476Z	E CAPACITOR 47μF,6.3V	C727		QEKJ1CM-106Z	E CAPACITOR 10μF,16V
C162		NCB21EK-104X	CAPACITOR 0.1μF,25V	C728		QEKJ1CM-106Z	E CAPACITOR 10μF,16V
C163		QEKJ1HM-475Z	E CAPACITOR 4.7μF,50V	C729		QEKJ1CM-106Z	E CAPACITOR 10μF,16V
C164		NDC21HJ-470X	CAPACITOR 47pF,50V	C730		QEKJ1HM-105Z	E CAPACITOR 1μF,50V
C165		NCB21HK-102X	CAPACITOR 0.001μF,50V	C731		QEKJ1CM-106Z	E CAPACITOR 10μF,16V
C166		NCF21HZ-104X	CAPACITOR 0.1μF,50V	C801		QEKJ0JM-476Z	E CAPACITOR 47μF,6.3V
C167		QEKJ0JM-476Z	E CAPACITOR 47μF,6.3V	C802		QEKJ1HM-105Z	E CAPACITOR 1μF,50V
C168		NCF21HZ-104X	CAPACITOR 0.1μF,50V	C804		NCB21EK-104X	CAPACITOR 0.1μF,25V
C169		NCB21EK-104X	CAPACITOR 0.1μF,25V	C807		NCB21HK-103X	CAPACITOR 0.01μF,50V
C170		NCB21HK-103X	CAPACITOR 0.01μF,50V	C808		NCB21HK-103X	CAPACITOR 0.01μF,50V
C171		NCF21HZ-104X	CAPACITOR 0.1μF,50V	C809		QEKJ0JM-476Z	E CAPACITOR 47μF,6.3V
C172		X-CS0RB0216K	CAPACITOR 1μF,16V	C810		QEKJ1HM-225Z	E CAPACITOR 2.2μF,50V
C173		NCF21HZ-104X	CAPACITOR 0.1μF,50V	C812		QEKJ1HM-225Z	E CAPACITOR 2.2μF,50V

#	△	REF No.	PART No.	PART NAME, DESCRIPTION	#	△	REF No.	PART No.	PART NAME, DESCRIPTION
C815			NCB21EK-104X	CAPACITOR	C4601		QEKJ0JM-476Z	E CAPACITOR	47μF,6.3V
C816			NCB21EK-104X	CAPACITOR	C4602		X-CS0RCH4H2J	CAPACITOR	220pF,50V
C821			QEKJ1HM-105Z	E CAPACITOR	C4603		NCF21HZ-104X	CAPACITOR	0.1μF,50V
C822			NCB21HK-103X	CAPACITOR	C4604		NDC21HJ-100X	CAPACITOR	10pF,50V
C824			NDC21HJ-470X	CAPACITOR	C4605		QEKJ1HM-105Z	E CAPACITOR	1μF,50V
C825			QCSB1HJ-470Y	CAPACITOR	C4606		NCB21HK-223X	CAPACITOR	0.022μF,50V
C835			NCB21EK-104X	CAPACITOR	C4607		NCB21HK-103X	CAPACITOR	0.01μF,50V
C837			NCB21EK-104X	CAPACITOR	C4608		NCF21HZ-104X	CAPACITOR	0.1μF,50V
C1703			QEKJ1CM-106Z	E CAPACITOR	C4609		QEKJ1HM-225Z	E CAPACITOR	2.2μF,50V
C1707			QETN1VM-226Z	E CAPACITOR	C4610		X-CS0RCH4H2J	CAPACITOR	220pF,50V
C1708			QETN1HM-105Z	E CAPACITOR	C4611		X-CS0RCH4E2J	CAPACITOR	150pF,50V
C1710			QETN0JM-477Z	E CAPACITOR	C4612		NCB21HK-222X	CAPACITOR	0.0022μF,50V
C1711			QETN0JM-477Z	E CAPACITOR	C4613		NDC21HJ-681X	CAPACITOR	680pF,50V
C1712			QETN1HM-106Z	E CAPACITOR	C4614		NCB21HK-222X	CAPACITOR	0.0022μF,50V
C1713			QETN0JM-107Z	E CAPACITOR	C4615		QEKJ1HM-474Z	E CAPACITOR	0.47μF,50V
C1714			QETN1CM-477Z	E CAPACITOR	C4616		NCF21HZ-103X	CAPACITOR	0.01μF,50V
C3002			QETN1VM-337Z	E CAPACITOR	C4617		NDC21HJ-750X	CAPACITOR	75pF,50V,CH
C3007			X-CS0KCH4G1J	CAPACITOR	C4619		NCF21HZ-104X	CAPACITOR	0.1μF,50V
C3008			X-CS0KCH4G1J	CAPACITOR	C4620		NDC21HJ-121X	CAPACITOR	120pF,50V,CH
C3009			X-CS0KCH4G1J	CAPACITOR	C4621		NCB21HK-103X	CAPACITOR	0.01μF,50V
C3010			X-CS0KCH4G1J	CAPACITOR	C4622		QEKJ1CM-106Z	E CAPACITOR	10μF,16V
C3011			NCF21HZ-104X	CAPACITOR	C4623		NDC21HJ-101X	CAPACITOR	100pF,50V
C3015			QEKJ1HM-105Z	E CAPACITOR	C4624		NCB21HK-102X	CAPACITOR	0.001μF,50V
C3016			QEK21EZ-474X	CAPACITOR	C4625		QEKJ1HM-474Z	E CAPACITOR	0.47μF,50V
C3018			NCB21EK-104X	CAPACITOR	C4626		QCB1HK-103Y	CAPACITOR	0.01μF,50V
C3019			QEKJ1CM-106Z	E CAPACITOR	C8002		NCF21HZ-104X	CAPACITOR	0.1μF,50V
C3020			QEKJ1HM-475Z	E CAPACITOR	C8003		NCF21HZ-104X	CAPACITOR	0.1μF,50V
C3021			NCB21HK-392X	CAPACITOR	C8004		QEKJ0JM-476Z	E CAPACITOR	47μF,6.3V
C3022			X-E5JXTP473Z	E CAPACITOR	C8005		NDC21HJ-101X	CAPACITOR	100pF,50V
C3023			NCB21HK-392X	CAPACITOR	C8006		X-CS0RCH4H2J	CAPACITOR	220pF,50V
C3024			NCF21HZ-104X	CAPACITOR	C8007		NCB21HK-103X	CAPACITOR	0.01μF,50V
C3025			X-CS0RB04U3K	CAPASITOR	C8008		X-E02LU0331M	E CAPACITOR	330μF,6.3V
C3026			NCB21HK-332X	CAPACITOR	C8009		NCB21EK-104X	CAPACITOR	0.1μF,25V
C3027			X-CS0RCH4E2J	CAPACITOR	C8010		NCF21HZ-104X	CAPACITOR	0.1μF,50V
C3028			QEKJ1CM-106Z	E CAPACITOR	C8011		NCB21HK-103X	CAPACITOR	0.01μF,50V
C3029			NCF21HZ-104X	CAPACITOR	C8012		NCB21HK-103X	CAPACITOR	0.01μF,50V
C3030			QEKJ1CM-106Z	E CAPACITOR	C8013		X-CSORB0216K	CAPACITOR	1μF,16V
C3031			NCF21HZ-104X	CAPACITOR	C8014		QETN1CM-477Z	E CAPACITOR	470μF,16V
C3032			QEKJ0JM-476Z	E CAPACITOR	C8015		X-CSORB0216K	CAPACITOR	1μF,16V
C3033			QEKJ0JM-476Z	E CAPACITOR	C8016		QEKJ1HM-105Z	E CAPACITOR	1μF,50V
C3034			NCF21HZ-104X	CAPACITOR	C8017		QEKJ1HM-105Z	E CAPACITOR	1μF,50V
C3035			NCB21HK-103X	CAPACITOR	C8018		NCB21HK-223X	CAPACITOR	0.022μF,50V
C3036			NCB21HK-222X	CAPACITOR	C8019		NCB21HK-103X	CAPACITOR	0.01μF,50V
C3037			NCB21HK-102X	CAPACITOR	C8020		QEKJ0JM-476Z	E CAPACITOR	47μF,6.3V
C3038			QCFB1HZ-104Y	CAPACITOR	C8021		X-E02LU0331M	E CAPACITOR	330μF,6.3V
C3039			NCB21EK-104X	CAPACITOR	C8022		QEKJ1HM-475Z	E CAPACITOR	4.7μF,50V
C3040			NCB21HK-103X	CAPACITOR	C8023		NCB21EK-104X	CAPACITOR	0.1μF,25V
C4501			X-CS0KY0313M	CAPACITOR	C8024		QEKJ1CM-106Z	E CAPACITOR	10μF,16V
C4503			QEKJ1HM-105Z	E CAPACITOR	C8025		QEKJ1HM-105Z	E CAPACITOR	1μF,50V
C4504			X-CS0RCH4L1J	CAPACITOR	C8026		NCB21HK-102X	CAPACITOR	0.001μF,50V
C4505			X-CS0KCH411D	CAPACITOR	C8027		X-CSORB0216K	CAPACITOR	1μF,16V
C4506			X-CS0KCH4H1J	CAPACITOR	C8028		QEKJ1HM-105Z	E CAPACITOR	1μF,50V
C4507			QEKJ1HM-105Z	E CAPACITOR	C8029		X-CSORB0216K	CAPACITOR	1μF,16V
C4508			X-CS0KCH4H1J	CAPACITOR	C8030		QEKJ1HM-105Z	E CAPACITOR	1μF,50V
C4510			NDC21HJ-271X	CAPACITOR	C8031		NCB21HK-102X	CAPACITOR	0.001μF,50V
C4511			QEKJ0JM-476Z	E CAPACITOR	C8032		QEKJ1HM-105Z	E CAPACITOR	1μF,50V
C4512			NCF21HZ-104X	CAPACITOR	C8033		QEKJ1HM-105Z	E CAPACITOR	1μF,50V
C4514			NCF21HZ-104X	CAPACITOR	C8035		NCB21EK-104X	CAPACITOR	0.1μF,25V
C4515			QEKJ0JM-476Z	E CAPACITOR	C8036		NCB21HK-103X	CAPACITOR	0.01μF,50V
C4516			X-E02LU54R7M	E CAPACITOR	C8038		QEKJ1HM-105Z	E CAPACITOR	1μF,50V
C4517			X-CS0KY0313M	CAPACITOR	C8040		X-E00NU5010M	E CAPACITOR	1μF,50V

#	△ REF No.	PART No.	PART NAME, DESCRIPTION	#	△ REF No.	PART No.	PART NAME, DESCRIPTION
		C8041	QEKJ1HM-105Z E CAPACITOR 1μF,50V			D8006	1SS133-T2 DIODE
		C8043	QETN0JM-477Z E CAPACITOR 470μF,6.3V			D8007	1SS133-T2 DIODE
		C8045	QEKJ1HM-105Z E CAPACITOR 1μF,50V			D8009	1SS133-T2 DIODE
		C8046	NCF21HZ-104X CAPACITOR 0.1μF,50V			D8010	1SS133-T2 DIODE
		C8047	X-CS0RB0216K CAPACITOR 1μF,16V			D8013	MTZJ4.7(B)-T2 ZENER MTZJ4.7BT-77
		C8048	QEKJ1HM-105Z E CAPACITOR 1μF,50V			V651	X-0040F94003 LED DISPLAY
		C8049	X-CS0RB0216K CAPACITOR 1μF,16V			IC101	X-I04F38217F IC HA118217F
		C8050	QEKJ1CM-226Z E CAPACITOR 22μF,16V			IC102	X-I55F0384FU IC TC7SB384FU
		C8051	QETN0JM-477Z E CAPACITOR 470μF,6.3V			IC701	X-I0KF79605H IC TDA9605H
		C8052	NCB21HK-102X CAPACITOR 0.001μF,50V			IC801	TDA9874H-X IC
		C8053	QETN0JM-477Z E CAPACITOR 470μF,6.3V			IC3001	X-I56F57079C IC OEC7079C
		C8054	NCB21HK-102X CAPACITOR 0.001μF,50V			IC3004	X-I9UF032310 IC PST3231NR
		C8057	X-CS0KCH411D CAPACITOR 10pF,50V			IC3005	X-I56F07080A IC OEC7080A
		C8059	QETN0JM-477Z E CAPACITOR 470μF,6.3V			IC3099	S-24C08ADP IC
		C8062	NDC21HJ-471X CAPACITOR 470pF,50V			IC4501	X-I53J4775MA IC LC74775M-9839
		C8067	NDC21HJ-471X CAPACITOR 470pF,50V			IC4601	LA7358 IC
		C8068	NDC21HJ-471X CAPACITOR 470pF,50V			IC8001	X-I03F030260 IC LA73026V
		C8072	NDC21HJ-101X CAPACITOR 100pF,50V			IC8002	X-I0QF02533V IC NJM2533V(TE2)
		C8073	NDC21HJ-471X CAPACITOR 470pF,50V			IC8004	NJM4580M IC
		C8078	NDC21HJ-471X CAPACITOR 470pF,50V			Q102	X-TCAT032034 TRANSISTOR KTC3203_Y-AT
		C8079	NDC21HJ-471X CAPACITOR 470pF,50V			Q104	X-TCAT032034 TRANSISTOR KTC3203_Y-AT
		C8081	NDC21HJ-471X CAPACITOR 470pF,50V			Q105	X-TPAAC05002 TRANSISTOR KRA103SRTK
		C8082	NDC21HJ-471X CAPACITOR 470pF,50V			Q106	X-TCATC31980 TRANSISTOR KTC3198-AT(Y,GR)
		C8084	X-E02LU2101M E CAPACITOR 100μF,16V			Q107	X-TCATC31980 TRANSISTOR KTC3198-AT(Y,GR)
		C8085	QETN0JM-477Z E CAPACITOR 470μF,6.3V			Q108	DTC143EKA-X TRANSISTOR
		C8087	X-E62KU52R2M E CAPACITOR 2.2μF,50V			Q109	KRC103S-X TRANSISTOR
		C8088	X-E62KU52R2M E CAPACITOR 2.2μF,50V			Q110	DTC143EKA-X TRANSISTOR
		C8089	NDC21HJ-821X CAPACITOR 820pF,50V			Q111	X-TCAA3875SY TRANSISTOR KTC3875S_Y_RTK
		C8090	NDC21HJ-821X CAPACITOR 820pF,50V			Q112	X-TPATC03002 TRANSISTOR KRA103MAT
		C8091	QEKJ1AM-336Z E CAPACITOR 33μF,10V			Q113	DTC143EKA-X TRANSISTOR
		C8092	NCB21HK-152X CAPACITOR 0.0015μF,50V			Q651	X-TPAAC05002 TRANSISTOR KRA103SRTK
		C8093	NCB21HK-152X CAPACITOR 0.0015μF,50V			Q653	KRC103S-X TRANSISTOR
		C8094	NDC21HJ-101X CAPACITOR 100pF,50V			Q654	X-TAAA1504SY TRANSISTOR KTA1504S_Y_RTK
		C8095	NDC21HJ-101X CAPACITOR 100pF,50V			Q655	KRC103S-X TRANSISTOR
		C8096	QEKJ1HM-225Z E CAPACITOR 2.2μF,50V			Q656	KRC103S-X TRANSISTOR
		C8097	QEKJ1CM-226Z E CAPACITOR 22μF,16V			Q657	X-TAAA1504SY TRANSISTOR KTA1504S_Y_RTK
		C8098	QEKJ1CM-226Z E CAPACITOR 22μF,16V			Q658	KRC103S-X TRANSISTOR
		C8099	QEKJ1HM-225Z E CAPACITOR 2.2μF,50V			Q659	KRC103S-X TRANSISTOR
		C8100	NCF21HZ-104X CAPACITOR 0.1μF,50V			Q660	X-TAAA1504SY TRANSISTOR KTA1504S_Y_RTK
		C8101	QETN1CM-337Z E CAPACITOR 330μF,16V			Q661	KRC103S-X TRANSISTOR
		C8102	NDC21HJ-470X CAPACITOR 47pF,50V			Q662	X-TAAA1504SY TRANSISTOR KTA1504S_Y_RTK
		C8109	NDC21HJ-470X CAPACITOR 47pF,50V			Q663	KRC103S-X TRANSISTOR
		C8115	QEKJ1HM-475Z E CAPACITOR 4.7μF,50V			Q664	KRC103S-X TRANSISTOR
		C8116	X-CS0RCH4L1J CAPACITOR 33pF,50V			Q665	X-TAAA1504SY TRANSISTOR KTA1504S_Y_RTK
		C8117	NCF21HZ-103X CAPACITOR 0.01μF,50V			Q666	KRC103S-X TRANSISTOR
		C8118	QCBB1HK-103 CAPACITOR 0.01μF,50V			Q667	KRC103S-X TRANSISTOR
		C8118	QCBB1HK-103Y CAPACITOR 0.01μF,50V			△ Q1701	X-TCAT032034 TRANSISTOR KTC3203_Y-AT
		D101	1SS133-T2 DIODE			△ Q1702	X-TCAT03209Y TRANSISTOR KTC3209_Y-AT
		D652	X-0021E5Q210 LED LTL-1CHGE-002A			△ Q1703	X-TCAT03209Y TRANSISTOR KTC3209_Y-AT
		D656	X-D2WXN40050 DIODE 1N4005-EIC			Q1705	X-TCAA3875SY TRANSISTOR KTC3875S_Y_RTK
		D1702	MTZJ12C-T2 ZENER			△ Q1706	X-TAAT01241Y TRANSISTOR KTA1241_Y-AT
		D1703	1SS133-T2 DIODE			Q1707	X-TCAA3875SY TRANSISTOR KTC3875S_Y_RTK
		△ D1708	MTZJ13B-T2 ZENER			△ Q1708	X-TCAT03209Y TRANSISTOR KTC3209_Y-AT
		D1709	1SS133-T2 DIODE			Q1709	KRC103S-X TRANSISTOR
		△ D1710	MTZJ10B-T2 ZENER			Q1711	KRC103S-X TRANSISTOR
		D3001	X-0010100320 INFRARED LED LNA2702L010R			△ Q1712	X-TCAT03209Y TRANSISTOR KTC3209_Y-AT
		D3002	1SS133-T2 DIODE			△ Q1713	X-TAAT012714 TRANSISTOR KTA1271_Y-AT
		D4601	1SS133-T2 DIODE			Q1714	KRC103S-X TRANSISTOR
		D8001	MTZJ6.8B-T2 ZENER			Q3001	X-0000M00390 PHOTO TRANSISTOR ST-304L
		D8004	MTZJ10B-T2 ZENER			Q3002	X-0000M00390 PHOTO TRANSISTOR ST-304L
		D8005	MTZJ10B-T2 ZENER			Q3003	KRC103S-X TRANSISTOR



#	△	REF No.	PART No.	PART NAME, DESCRIPTION	#	△	REF No.	PART No.	PART NAME, DESCRIPTION
Q3004			X-0002700680	PHOTO TRANSISTOR RPI-352C40N	L8017			X-021LA61R0M	COIL 1μH
Q3005			X-0002700680	PHOTO TRANSISTOR RPI-352C40N	J8001			X-060J401082	RCA JACK,COAXIAL
Q3006			X-0002700690	PHOTO COUPLER RPI-303	J8002			X-060J411020	RCA JACK,AUDIO OUT
Q3007			X-0002700690	PHOTO COUPLER RPI-303	J8003			X-063D700005	JACK,S
Q3008			KRC103S-X	TRANSISTOR	J8004			X-060J421023	RCA JACK,FRONT AUDIO(R) IN
Q3009			KRC103S-X	TRANSISTOR	J8005			X-063G000072	SOCKET,21PIN
Q4501			X-TAAA1504SY	TRANSISTOR KTA1504S_Y_RTK	J8006			X-060J401080	RCA JACK,FRONT AUDIO(L) IN
Q4601			X-TCAA3875SY	TRANSISTOR KTC3875S_Y_RTK	J8007			X-060J401079	RCA JACK,FRONT VIDEO IN
Q4602			X-TAAA1504SY	TRANSISTOR KTA1504S_Y_RTK	SW651			QSW0456-001Z	TACT SWITCH,EJECT
Q4603			X-TCAA3875SY	TRANSISTOR KTC3875S_Y_RTK	SW652			QSW0456-001Z	TACT SWITCH,POWER
Q4604			KRC103S-X	TRANSISTOR	SW653			QSW0456-001Z	TACT SWITCH,VCR/DVD
Q4605			X-TCAA3875SY	TRANSISTOR KTC3875S_Y_RTK	SW654			QSW0456-001Z	TACT SWITCH,CH UP
Q4606			X-TCAA3875SY	TRANSISTOR KTC3875S_Y_RTK	SW655			QSW0456-001Z	TACT SWITCH,CH DOWN
Q8001			X-TAAA1504SY	TRANSISTOR KTA1504S_Y_RTK	SW3001			X-0508S11001	LEAF SWITCH,TAB
Q8002			X-TCAA3875SY	TRANSISTOR KTC3875S_Y_RTK	CP101			X-0697290620	CONNECTOR PCB SIDE
Q8003			X-TNAAD05001	TRANSISTOR KRC104SRTK	CP102			X-069J760029	CONNECTOR PCB SIDE
Q8004			X-TPAAB05001	TRANSISTOR KRA102SRTK	CP103			X-0697120320	CONNECTOR PCB SIDE
Q8012			KRC103S-X	TRANSISTOR	CP653			X-069J750019	CONNECTOR PCB SIDE
Q8013			X-TPAAA05001	TRANSISTOR KRA101SRTK	CP1701			X-069R2E0589	CONNECTOR PCB SIDE
Q8014			X-TCAA3875SY	TRANSISTOR KTC3875S_Y_RTK	CP3001			X-06972C0010	CONNECTOR PCB SIDE
Q8015			X-TCAA3875SY	TRANSISTOR KTC3875S_Y_RTK	CP8001			X-069S2D0629	CONNECTOR PCB SIDE
B8001			X-024HT03564	CORE,BEADS	CP8002			X-069J710019	CONNECTOR PCB SIDE
B8005			X-024HT03564	CORE,BEADS	X101			X-100CT4R407	CRYSTAL HC-49/U
L103			QQL29BJ-101Z	COIL 100μH	X801			X-100CT02401	CRYSTAL HC-49/U
L104			X-031616003R	COIL,BIAS OSC	X3001			QAX0236-001	CRYSTAL 32.768KHz
L105			QQL29BJ-220Z	COIL 22μH	X3002			X-100CT01207	CRYSTAL HC-49/U-S
L106			QQL29BJ-101Z	COIL 100μH	X3003			X-1001T4R010	CERAMIC OSCILLATOR EFOMC4004T4
L107			X-021LA6R22M	COIL 0.22μH	△ TU301			X-0162K17001	RF UNIT
L108			X-021LA6R22M	COIL 0.22μH	CUS011			X-800WFAA008	CUSHION C
L109			X-021LA6R22M	COIL 0.22μH	OS651			X-077Q037001	REMOTE RECEIVER
L110			QQL29BJ-101Z	COIL 100μH	OS8001			GP1FA550TZ	OPTICAL DEVICE GP1FA550TZ
L111			QQL231K-221Y	COIL 220μH					
L112			X-021LA6120K	COIL 12μH					
L113			QQL29BJ-220Z	COIL 22μH					
L116			QQL29BJ-101Z	COIL 100μH					
L701			QQL29BJ-101Z	COIL 100μH					
L702			QQL29BJ-101Z	COIL 100μH					
L802			QQL29BJ-220Z	COIL 22μH					
L4501			NQL024J-330X	COIL 39μH					
L4502			NQL024J-330X	COIL 33μH					
L4503			QQL231K-220Y	COIL 22μH					
L4504			QQL231K-2R2Y	COIL 2.2μH					
L4505			QQL29BJ-101Z	COIL 100μH					
L4506			QQL231K-220Y	COIL 22μH					
L4601			QQL29BJ-470Z	COIL 47μH					
L4602			QQL231K-6R8Y	COIL 6.8μH					
L4603			QQL231K-270Y	COIL 27μH					
L4604			QQL231K-680Y	COIL 68μH					
L4605			QQL231K-101Y	COIL 100μH					
L8001			QQL231K-101Y	COIL 100μH					
L8002			QQL29BJ-101Z	COIL 100μH					
L8003			QQL231K-101Y	COIL 100μH					
L8004			QQL29BJ-101Z	COIL 100μH					
L8005			QQL29BJ-101Z	COIL 100μH					
L8006			X-021LA6R27M	COIL 0.27μH					
L8007			X-021LA6R27M	COIL 0.27μH					
L8008			QQL29BJ-470Z	COIL 47μH					
L8009			QQL231K-100Y	COIL 10μH					
L8010			QQL231K-100Y	COIL 10μH					
L8011			QQL231K-100Y	COIL 10μH					
L8015			QQL231K-100Y	COIL 10μH					